

SC921

Bridge Type Load Cell

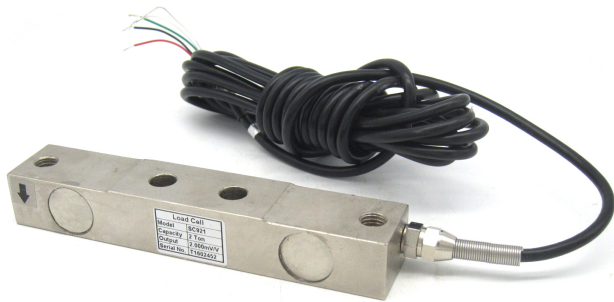

Application: Truck scales, weighing balance.

Size: mm

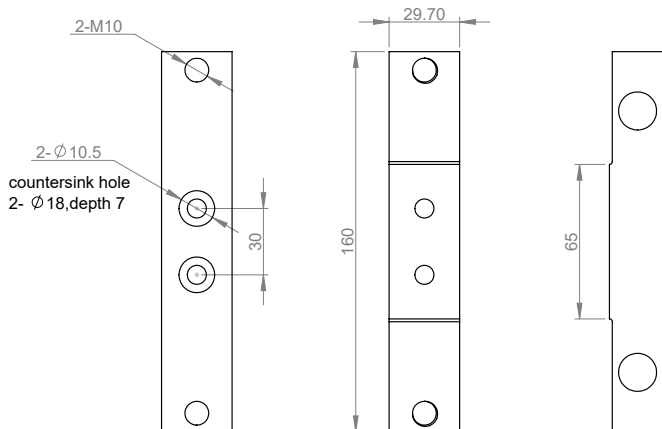
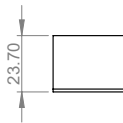

Specification:

Capacity	2T
Rated output	2.0±0.05mV/V
Accuracy class	C1: 0.05%F·S C2: 0.03%F·S
Combined error	≤± 0.03%F·S
Creep	0.02%F·S/30min
Temp. effect on sensitivity	0.0017%F·S/° C
Temp. effect on zero	0.005%F·S/° C
Zero balance	±1.0%F·S
Input resistance	365±5 Ω
Output resistance	350±3 Ω
Insulation resistance	5000 MΩ(50V)
Excitation voltage	5~12V
Compensated temp. range	-10~+40° C
Operating temp. range	-35~+80° C
Safe overload	150 %F·S
Ultimate overload	200%F·S
Load cell material	Alloy steel
Connecting cable	Φ5.0x3.5m

Wiring

